

Chris Craft 60 Roamer MY

1974-76

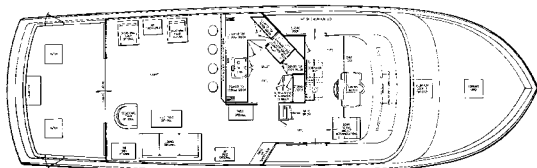

Although the last Roamer 60 Motor Yacht was built in 1976, these spacious yachts continue to maintain their popularity thanks to their comfortable accommodations and durable aluminum construction. (Note that she is often referred to among brokers as the Roamer 60 “Houseboat” to differentiate her from the Roamer 60 Flush Deck model.) Several galley-up floorplans were offered during her brief three-year production run and all were arranged with a companionway between the walk-in engine rooms and crew quarters, with a galley and dinette, forward. (Significantly, the 60 Roamer MY is probably the smallest successful motor yacht design to offer split owner’s party/crew accommodations.) The main galley, on the deckhouse level, opens to the salon with a serving counter. The Roamer’s spacious full-width salon is one of the reasons for her enduring popularity, and it’s worth noting that a full-width salon configuration—common enough in many of today’s motor yacht designs—was a bold concept back in the 1970s. The flybridge, accessed from the wheelhouse, is enormous. Twin 12V71TI Detroit diesels cruise at 16–17 knots (18–20 knots top). A total of 20 of these yachts were built.

Specifications

Length.....	60'0"	Fuel	1,260 gals.
Beam.....	17'2"	Water	300 gals.
Draft.....	4'6"	Construction	Aluminum
Weight.....	70,000#	Hull Type	Modified-V
Clearance	17'0"	Deadrise Aft	NA